

First Piece

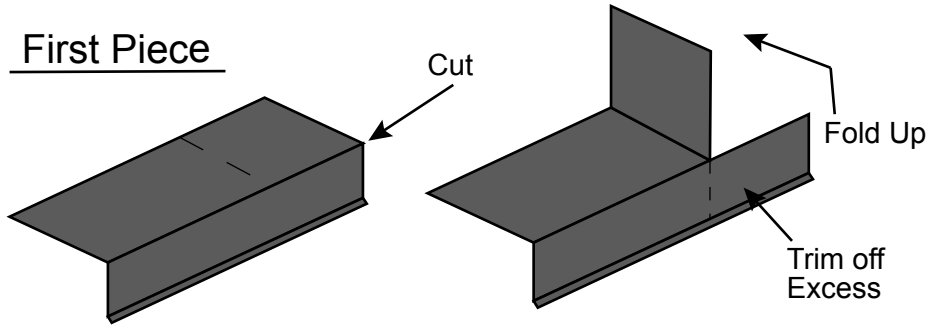

Second Piece

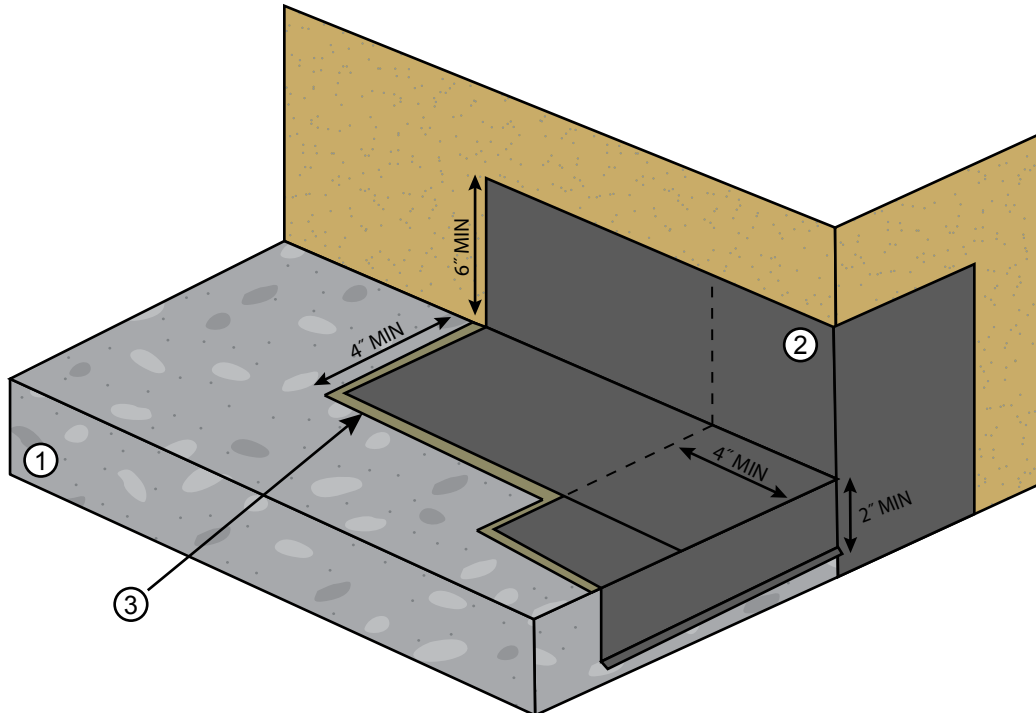
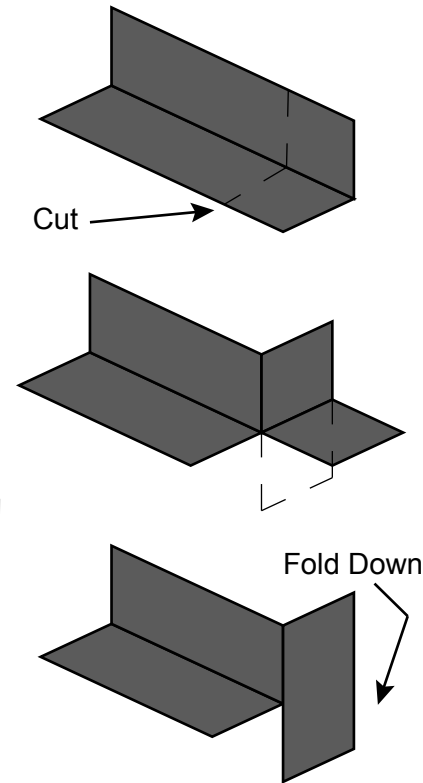

KEYNOTES

- ① Concrete Substrate (by others)
- ② EC-72 Epoxy Patch Gel
- ③ Bonderized Sheet Metal

IAPMO ER-517

- Concrete must be a min 2" thick & 2,500 PSI.
- Concrete should be prepared to a profile equal to CSP 3.
- Standard overlap is bottom to top with a 4" overlap.
- Apply WP-53 on all flashing seams and overlaps.
- Minimum 1/4" slope required on all decks
- Refer to local building codes and standards.
- Refer to all related Product and System Specifications for additional information.

All details are for reference only and should be evaluated by architect. These details are not a substitute for specifications, plans or evaluation reports. Architect, consultant or similar professional should review prior to major waterproofing applications.

REV. 9/2/25 TC

SHUR DECK OVER CONCRETE
OUTSIDE CORNER FLASHING DECK TERMINATION DETAIL

DIVISION 07 18 13
Pedestrian Traffic Coatings

SCALE : NTS



westcoat

4007 Lockridge Street • San Diego, CA • 92102
800.250.4519 • westcoat.com