

Notes:

- Apply WP-53 on all Flashing Seams and Overlaps.
- Standard Overlap is Bottom to Top with a 4" Overlap
- Minimum 5/8" Exterior Grade Plywood.
- 1/4 Minimum Slope Required on all Decks.
- Refer to all Local Building Codes and Standards.
- Refer to all Related Product and System Specifications for Additional Information.

All details are for reference only and should be evaluated by architect. These details are not a substitute for specifications, plans or evaluation reports. Architect, consultant or similar professional should review prior to major waterproofing applications.

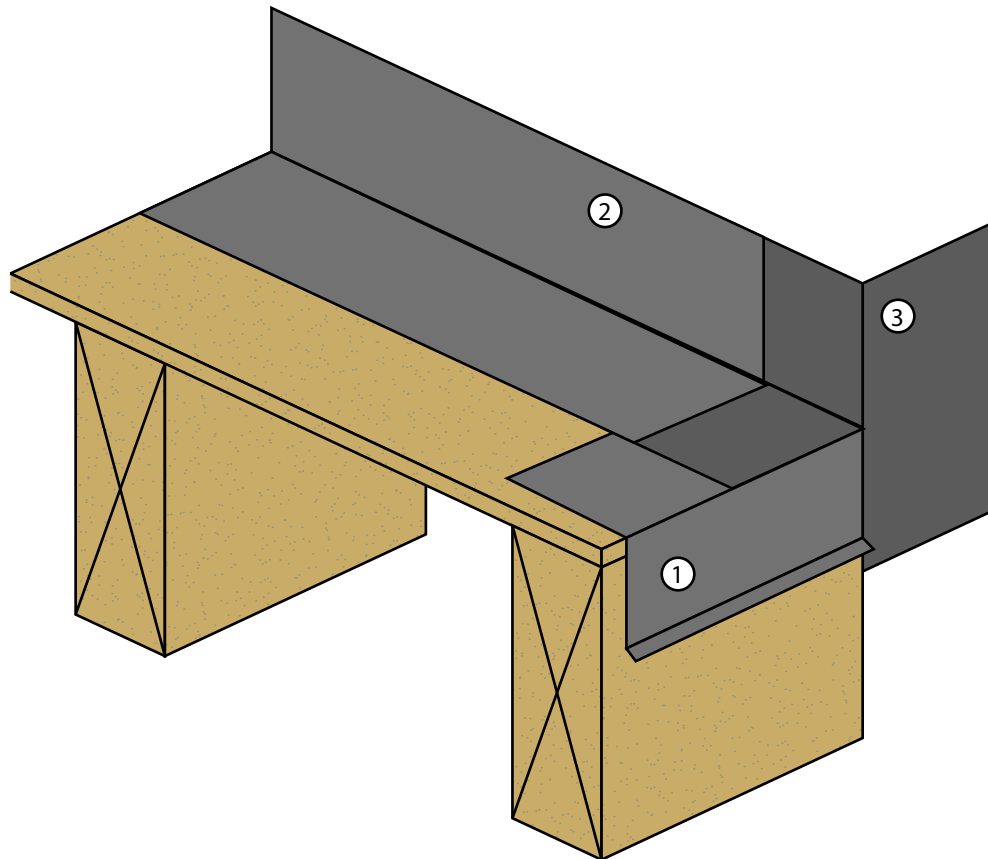

First Piece

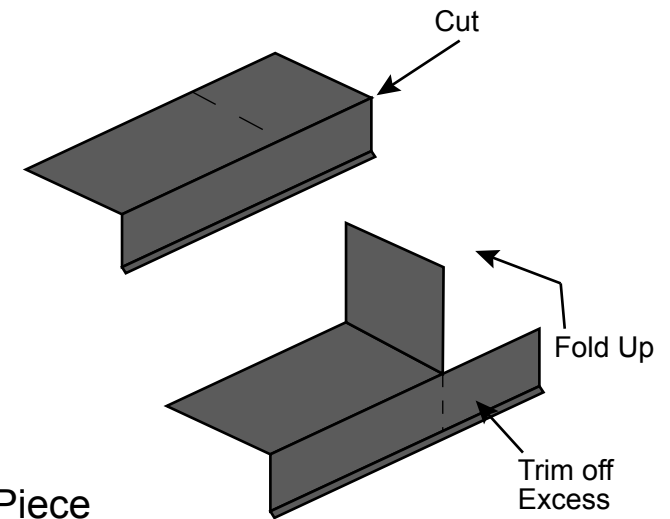

Second Piece

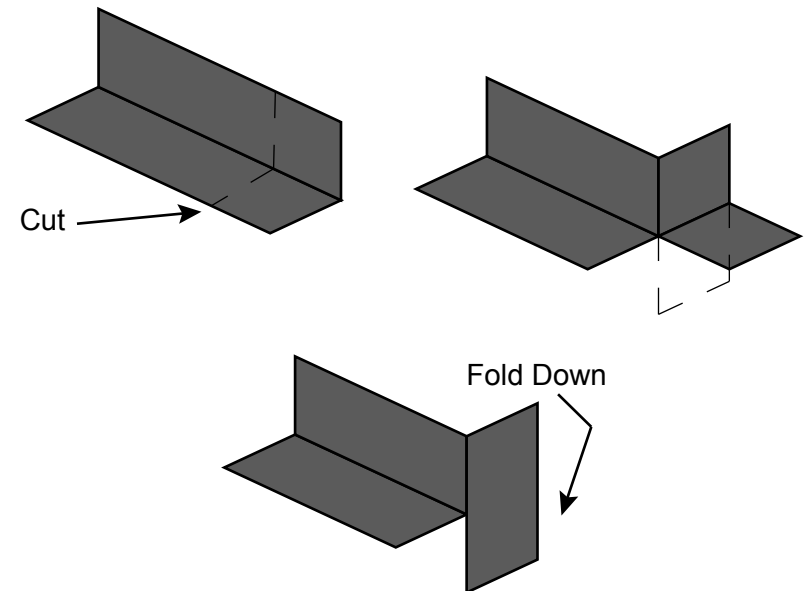

ALX SYSTEM - OUTSIDE CORNER FLASHING DECK TERMINATION DETAIL

DIVISION 07 18 13  
Pedestrian Traffic Coatings

SCALE : NTS



**westcoat**

4007 Lockridge Street • San Diego, CA • 92102  
800.250.4519 • westcoat.com